

CHASSIS BODY	WATER TANK
CHASSIS MODEL: SUTHPEN	WATER CAP. AM. GAL/INTAK. (MAX. 1000)
WHEEL BASE: 122'-5"	CLASS. B CASH. (MAX. 1000)
WHEEL SPACING: 49"	WHEELS: 4.75" x 16" x 14.5" (MAX. 1000)
CHASSIS WEIGHT: 12000 LBS	VEHICLE WEIGHT: 2200 LBS
VEHICLE WEIGHT: 14200 LBS	VEHICLE HEIGHT: 7'2"
CHASSIS WEIGHT: 14200 LBS	VEHICLE LENGTH: 169'
CHASSIS WEIGHT: 14200 LBS	VEHICLE WIDTH: 96"
CHASSIS WEIGHT: 14200 LBS	CHASSIS HEIGHT: 153"
CHASSIS WEIGHT: 14200 LBS	CHASSIS CLEARANCE: 14"

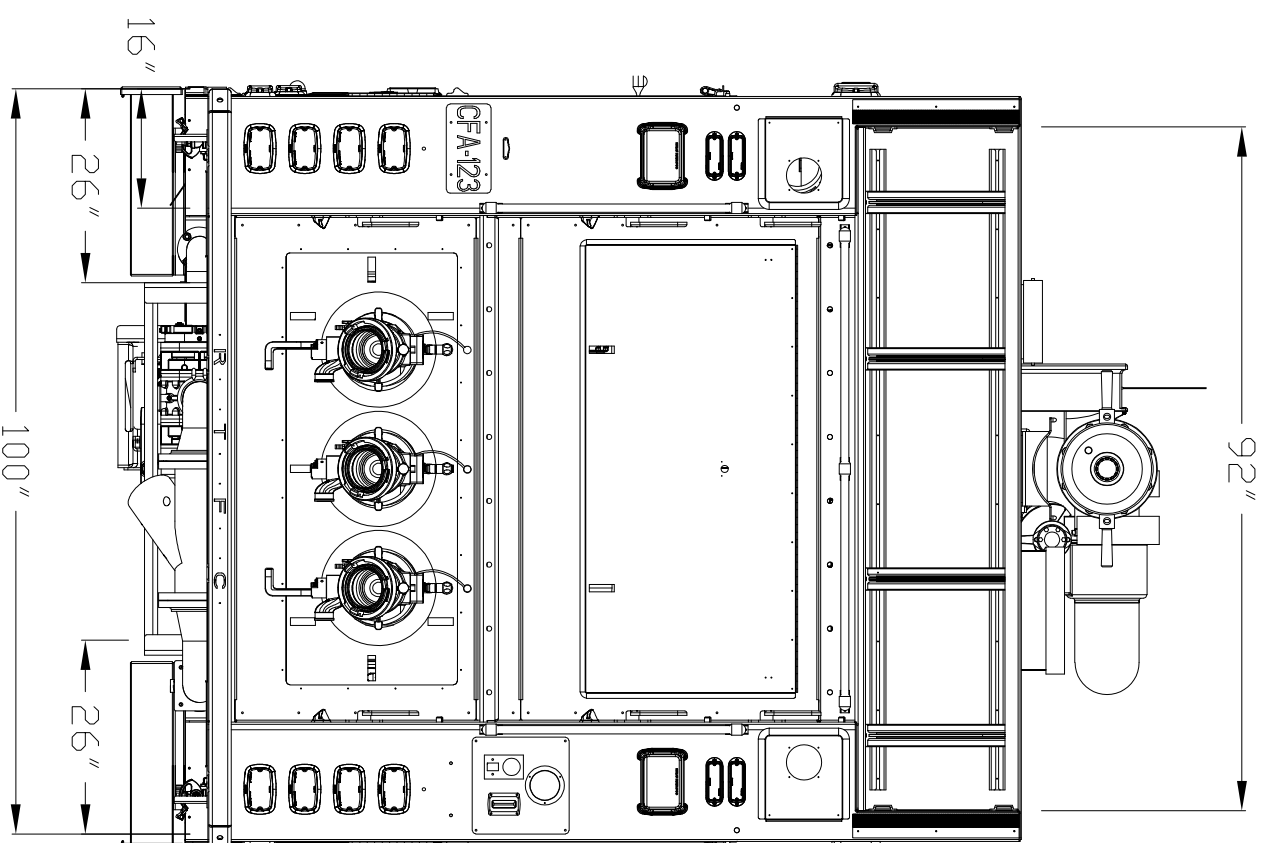
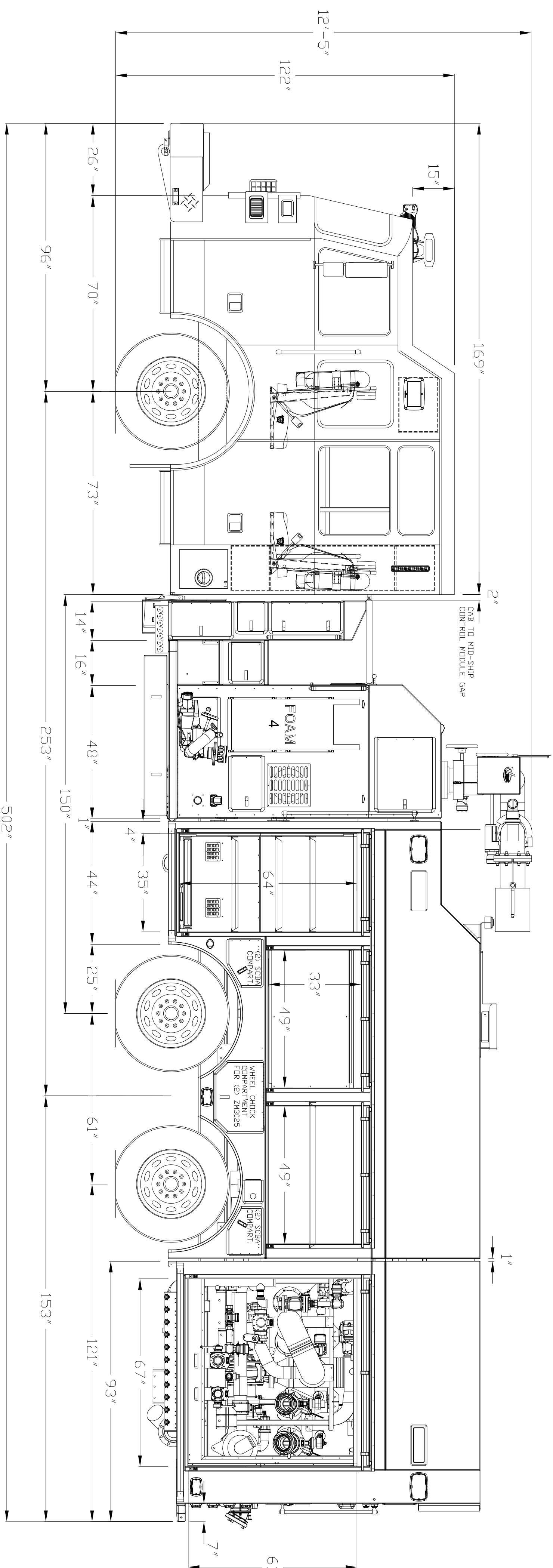

DIMENSIONS SHOWN ON THIS DRAWING ARE APPROXIMATE AND ARE SUBJECT TO MINOR DEVIATIONS DURING CONSTRUCTION.
IN THE EVENT OF A DISCREPANCY BETWEEN THE SUTHPEN SPECIFICATIONS AND DRAWING, THE SUTHPEN SPECIFICATIONS SHALL PREVAIL.
DRAWING IS FOR REFERENCE ONLY. SOME ITEMS PROPOSED MAY NOT BE SHOWN OR NOTED.

CUSTOMER APPROVAL

NAME:
TITLE:
DATE:

PER PRELIMINARY SPECS

REV: A

DESCRIPTION

LRD 03-01-2021

DRAWN BY: LRD
DATE: 03-01-2021

MFG. FACILITY: CFA

REFINERY TERMINAL FIRE CD
FOAM DELIVERY PUMPER - Custom Body
HS-TD BE DETERMINED

